

## STRONG BOX PULLER SET

To Parts List

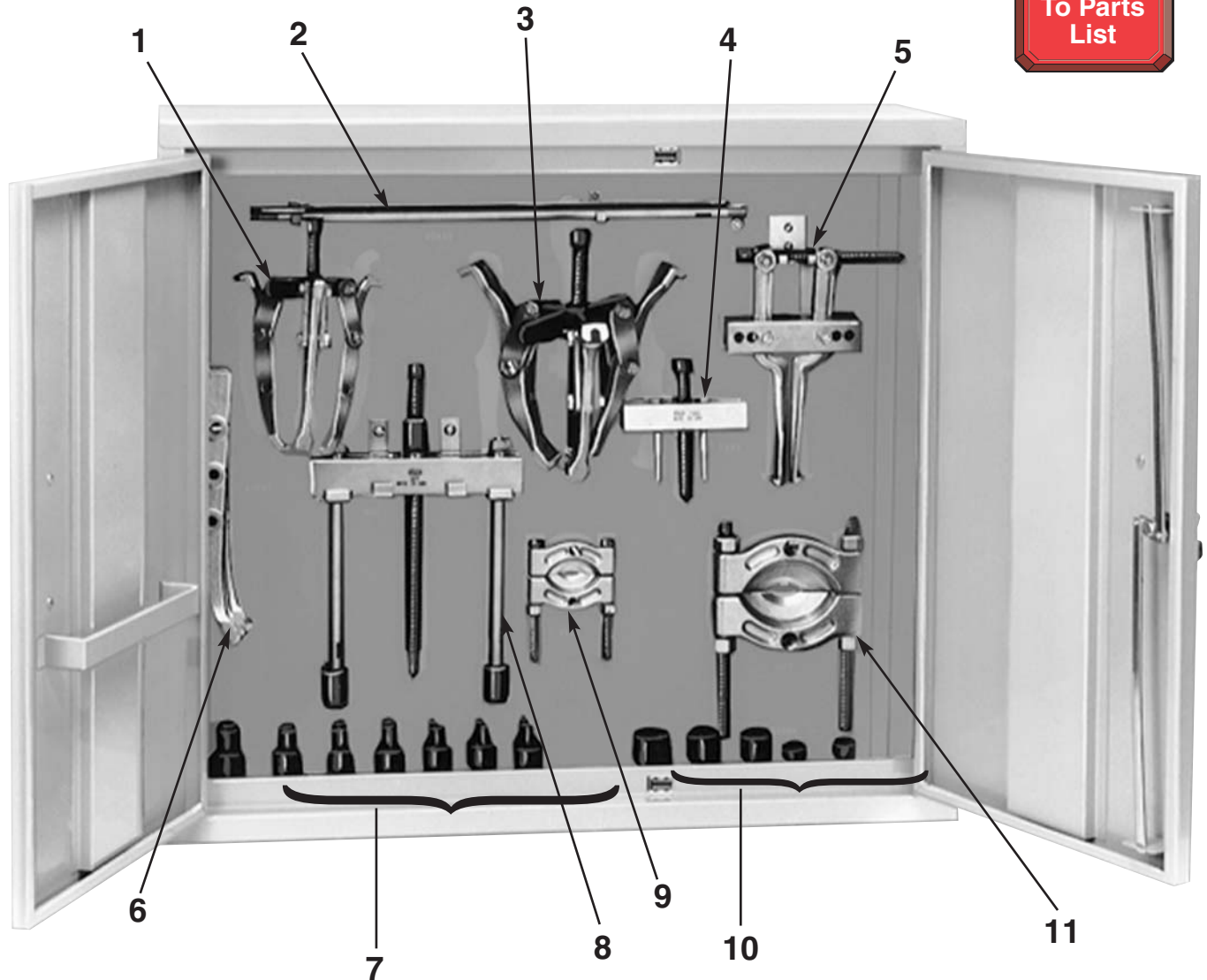

<b>Item No.</b>	<b>Part No.</b>	<b>No. Req'd</b>	<b>Description</b>
1	<b>1027</b>	1	Combination Puller (5 ton; 2/3 jaw)
2	<b>1101</b>	1 pr.	Puller Legs (15-3/4)
3	<b>1037</b>	1	Combination Puller (7 ton; 2/3 jaw)
4	<b>7393</b>	1	Gear and Pulley Puller
5	<b>1152</b>	1	Internal Pulling Attachment
6	<b>43892</b>	3	Long Jaw (For 1037)
7	<b>8005</b>	2	Male/Female Threaded Adapter (5/8 - 18 F. X 3/8 - 16 M.)
	<b>8006</b>	2	Male/Female Threaded Adapter (5/8 - 18 F. X 1/2 - 20 M.)
	<b>8007</b>	2	Male/Female Threaded Adapter (5/8 - 18 F. X 1/2 - 13 M.)
	<b>8010</b>	2	Male/Female Threaded Adapter (5/8 - 18 F. X 5/8 - 11 M.)
	<b>8013</b>	2	Male/Female Threaded Adapter (5/8 - 18 F. X 3/4 - 16 M.)
	<b>8015</b>	2	Male/Female Threaded Adapter (5/8 - 18 F. X 3/4 - 10 M.)
	<b>8019</b>	2	Male/Female Threaded Adapter (5/8 - 18 F. X 1" - 14 M.)
8	<b>927</b>	1	Push-puller (10 ton with 6-3/4 legs)
9	<b>1122</b>	1	Bearing Pulling Attachment
10	<b>8035</b>	1	Female Threaded Adapter (1/2 - 20 X 5/8 - 18)
	<b>8037</b>	1	Female Threaded Adapter (5/8 - 18 X 5/8 - 18)
	<b>8038</b>	1	Female Threaded Adapter (5/8 - 18 X 3/4 - 16)
	<b>8039</b>	1	Female Threaded Adapter (5/8 - 18 X 7/8 - 14)
	<b>8040</b>	1	Female Threaded Adapter (5/8 - 18 X 1" - 14)
11	<b>1123</b>	1	Bearing Pulling Attachment

**PARTS INCLUDED BUT NOT SHOWN**

<b>8050</b>	1	Shaft Protector (1-1/2 O.D.)
<b>8051</b>	1	Shaft Protector (1-1/4 O.D.)
<b>8052</b>	1	Shaft Protector (1" O.D.)
<b>8053</b>	1	Shaft Protector (3/4 O.D.)
<b>8057</b>	1	Step Plate Adapter (1" O.D. X 3/4 I.D.)
<b>8058</b>	1	Step Plate Adapter (1-1/8 O.D. X 7/8 I.D.)
<b>8059</b>	1	Step Plate Adapter (1-1/4 O.D. X 1" I.D.)
<b>8060</b>	1	Step Plate Adapter (1-3/8 O.D. X 1-1/8 I.D.)
<b>8061</b>	1	Step Plate Adapter (1-5/8 O.D. X 1-1/4 I.D.)
<b>8062</b>	1	Step Plate Adapter (1-3/4 O.D. X 1-3/8 I.D.)

