

## 17-1/2, 30 AND 50 TON CAPACITY PULLER SET

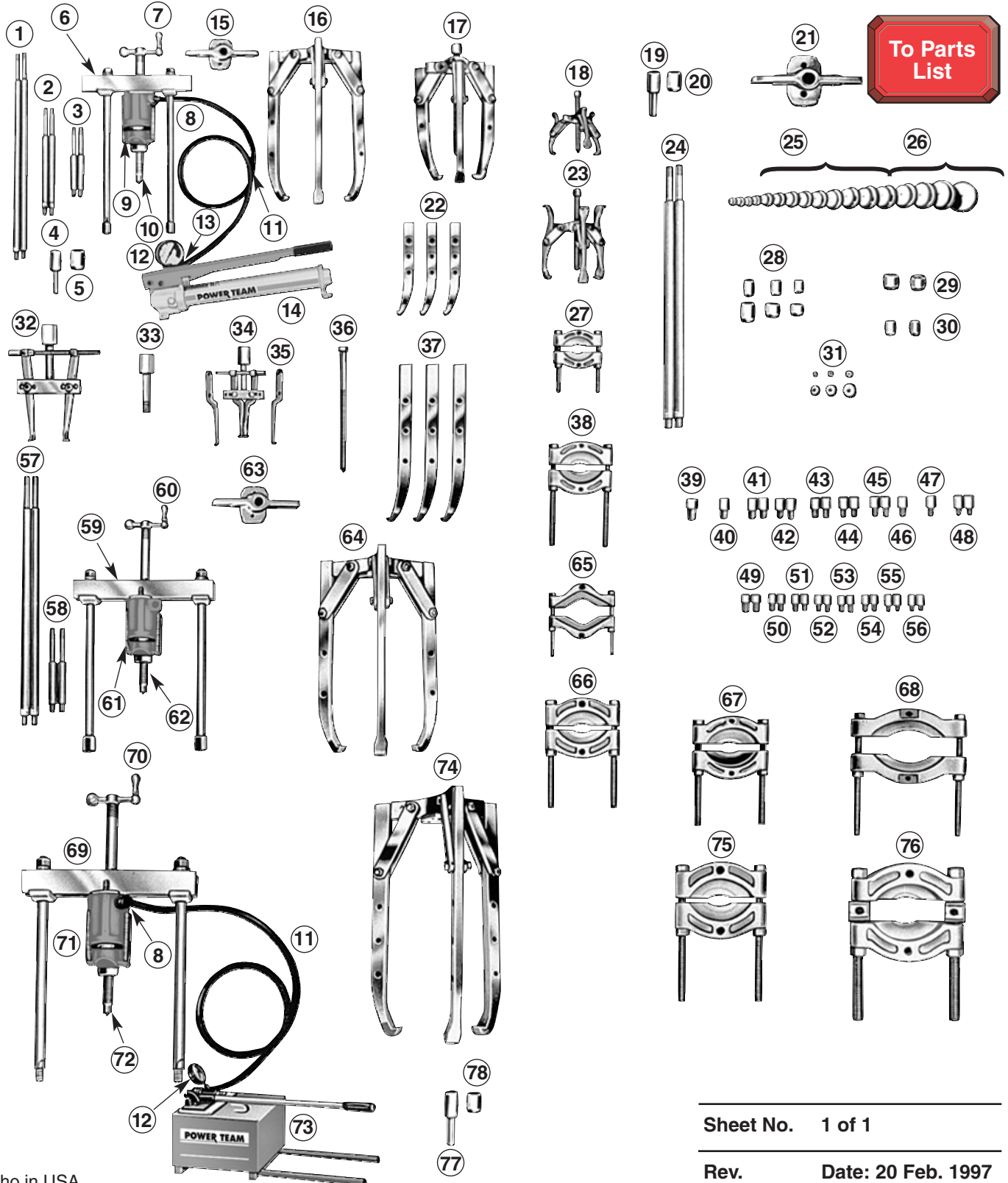

# Parts List, Form No. 101768, Back sheet 1 of 1

Item No.	Part No.	No. Req'd	Description	Item No.	Part No.	No. Req'd	Description
1	1105	1 pr.	Puller Legs (22 1/2"; For 1062)	44	8025	2	Male-Female Threaded Adapter (1 1/4" - 7 F. X 5/8 - 18 M.)
2	1106	1 pr.	Puller Legs (9 1/2"; For 1062)	45	8012	2	Male-Female Threaded Adapter (1" - 14 F. X 5/8 - 18 M.)
3	1107	1 pr.	Puller Legs (4 1/2"; For 1062)	46	8021	1	Male-Female Threaded Adapter (1" - 8 F. X 1" - 14 M.)
4	201923	1	Pushing Adapter	47	8020	1	Male-Female Threaded Adapter (1" - 8 F. X 5/8 - 18 M.)
5	28228	1	Cylinder Cap	48	8019	2	Male-Female Threaded Adapter (5/8 - 18 F. X 1" - 14 M.)
6	1062	1	Push-puller (17 1/2 ton with 16 1/2" legs)	49	8018	2	Male-Female Threaded Adapter (5/8 - 18 F. X 7/8 - 9 M.)
7	24814	1	Speed Crank	50	8017	2	Male-Female Threaded Adapter (5/8 - 18 F. X 7/8 - 14 M.)
8	9798	2	Hose Half Coupler	51	8015	2	Male-Female Threaded Adapter (5/8 - 18 F. X 3/4 - 10 M.)
9	RT172	1	Twin Cylinder With Threaded Insert (17 1/2 ton center-hole)	52	8013	2	Male-Female Threaded Adapter (5/8 - 18 F. X 3/4 - 16 M.)
10	32118	1	Cylinder Adjusting Screw	53	8010	2	Male-Female Threaded Adapter (5/8 - 18 F. X 5/8 - 11 M.)
11	9767	2	Hydraulic Hose 6'	54	8007	2	Male-Female Threaded Adapter (5/8 - 18 F. X 1/2 - 13 M.)
12	9059	2	Pressure Gauge	55	8006	2	Male-Female Threaded Adapter (5/8 - 18 F. X 1/2 - 20 M.)
13	9670	1	Tee Adapter	56	8005	2	Male-Female Threaded Adapter (5/8 - 18 F. X 3/8 - 16 M.)
14	P55	1	Hand Pump Assembly (Single-stage)	57	1111	1 pr.	Puller Legs (28"; For 1070)
15	41224	1	Puller Head (17 1/2 ton; 2 jaw)	58	1109	1 pr.	Puller Legs (8"; For 1070)
16	1066	1	Puller (17 1/2 ton; 3 jaw)	59	1070	1	Push-puller (30 ton; 18" Legs)
17	1041	1	Combination Puller (2/3 jaw)	60	27198	1	Speed Crank
18	1027	1	Combination Puller (2/3 jaw)	61	RT302	1	Twin Cylinder With Threaded Insert (30-ton center-hole)
19	34510	1	Pushing Adapter	62	34758	1	Cylinder Adjusting Screw
20	28229	1	Cylinder Cap	63	41226	1	Puller Head (30 ton; 2 jaw)
21	50449	1	Puller Head (50 ton; 2 jaw)	64	1074	1	Puller (30 ton 3 jaw)
22	43892	3	Long Jaws (For 1037)	65	679	1	Pulley Pulling Attachment
23	1037	1	Combination Puller (2/3 jaw)	66	1130	1	Bearing Pulling Attachment
24	1113	1	Puller Legs (34"; For 1076)	67	1126	1	Bearing Pulling Attachment
25	8075	11 pcs.	Step Plate Adapter Set	68	680	1	Pulley Pulling Attachment
26	8076	6 pcs.	Step Plate Adapter Set	69	1076	1	Push-puller (50 ton; 24" legs)
27	1122	1	Bearing Pulling Attachment	70	29595	1	Speed Crank
28	8044	6 pcs.	Female Threaded Adapter Set	71	RT503	1	Twin Cylinder With Threaded Insert (50 ton center hole)
29	8036	2	Female Threaded Adapter (1" - 14 F. X 1" - 14 F.)	72	32698	1	Cylinder Adjusting Screw
30	8038	2	Female Threaded Adapter (5/8 - 18 F. X 3/4 - 16 F.)	73	P460	1	Hand Pump With 3-Way Control Valve (Two-stage)
31	8056	6 pcs.	Shaft Protector Set	74	1080	1	Puller (50 ton; 3 jaw)
32	1166	1	Bearing Cup Pulling Attachment	75	1127	1	Bearing Pulling Attachment
33	34479	1	Reducing Adapter (For 1166)	76	1128	1	Bearing Pulling Attachment
34	1154	1	Bearing Cup Pulling Attachment	77	34755	1	Pushing Adapter
35	32136	2	Long Jaws (For 1154)	78	28230	1	Cylinder Cap
36	24832	1	Spec Puller Forcing Screw				
37	30902	3	Long Jaws (For 1041)				
38	1123	1	Bearing Pulling Attachment				
39	8029	1	Male-Female Threaded Adapter (1 5/8" - 5 1/2 F. X 1" - 14 M.)				
40	8028	1	Male-Female Threaded Adapter (1 5/8" - 5 1/2 F. X 1" - 8 M.)				
41	8024	2	Male-Female Threaded Adapter (1 1/4" - 12 F. X 1 3/4" - 12 M.)				
42	8023	2	Male-Female Threaded Adapter (1 1/4" - 12 F. X 1" - 14 M.)				
43	8027	2	Male-Female Threaded Adapter (1 1/4" - 7 F. X 1" - 14 M.)				

